

PROFILE PH2 - ROAD 1.5  
Horizontal Scale 1:1000  
Vertical Scale 1:100

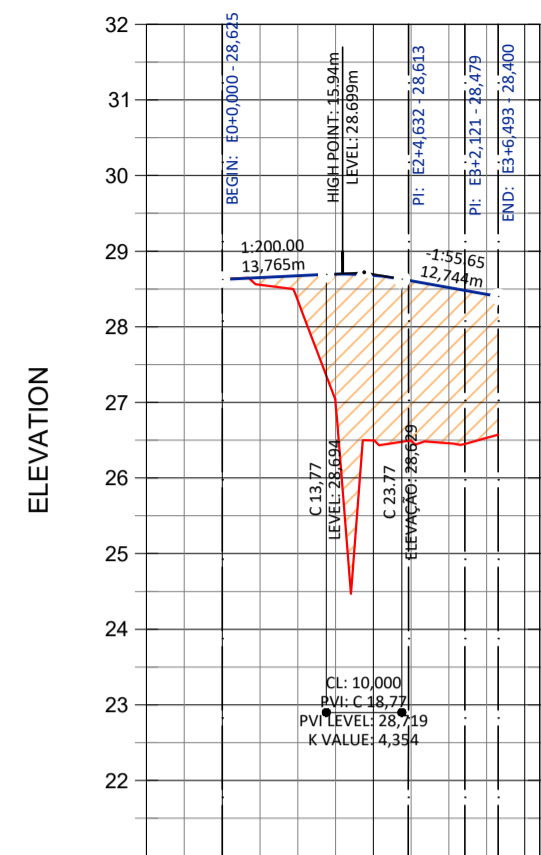

| CHAINAGE        | 0.00   | 20.00  | 40.00  |
|-----------------|--------|--------|--------|
| EXISTING GROUND | 26.638 | 26.638 | 26.498 |
| PROPOSED GROUND | 26.625 | 26.680 | 26.498 |
| CUT             | 0.01   |        |        |
| FILL            |        | 2.18   |        |

PROFILE PH2 - TENDER 1.1  
Horizontal Scale 1:1000  
Vertical Scale 1:100

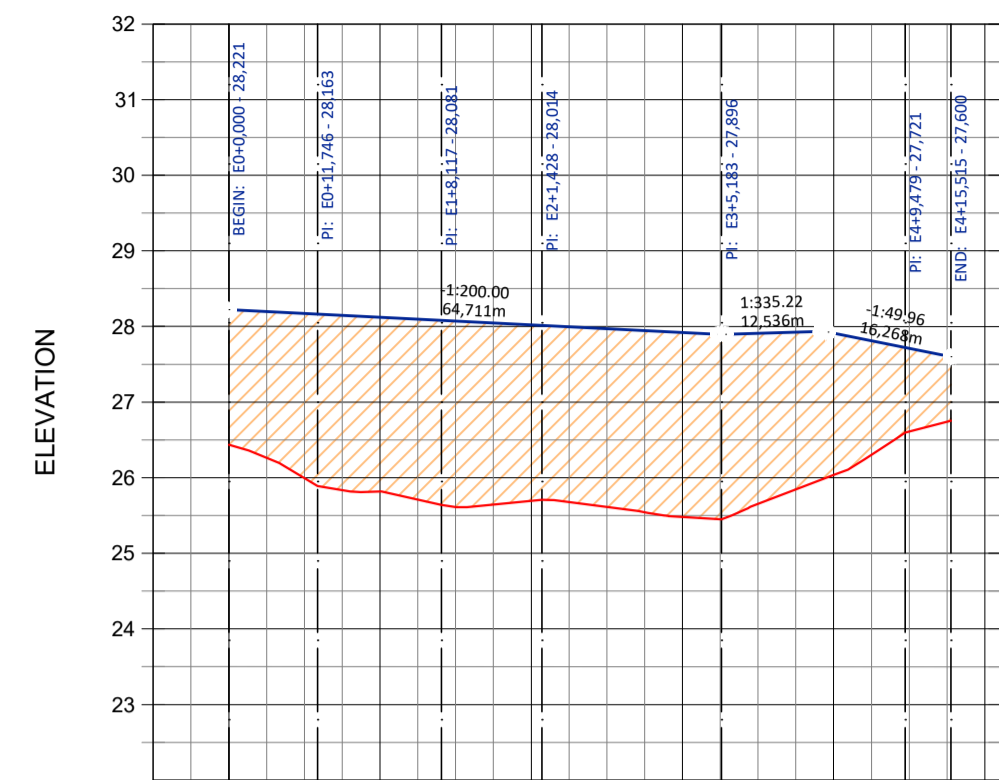

| CHAINAGE        | 0.00   | 20.00  | 40.00  | 60.00  | 80.00  | 100.00 |
|-----------------|--------|--------|--------|--------|--------|--------|
| EXISTING GROUND | 26.437 | 25.818 | 25.864 | 25.481 | 26.038 | 26.038 |
| PROPOSED GROUND | 26.221 | 26.121 | 26.021 | 25.481 | 27.011 | 26.038 |
| CUT             | 1.76   | 2.30   | 2.38   | 2.44   | 1.87   |        |
| FILL            |        |        |        |        |        | 26.038 |

PROFILE PH2 - TENDER 1.2  
Horizontal Scale 1:1000  
Vertical Scale 1:100

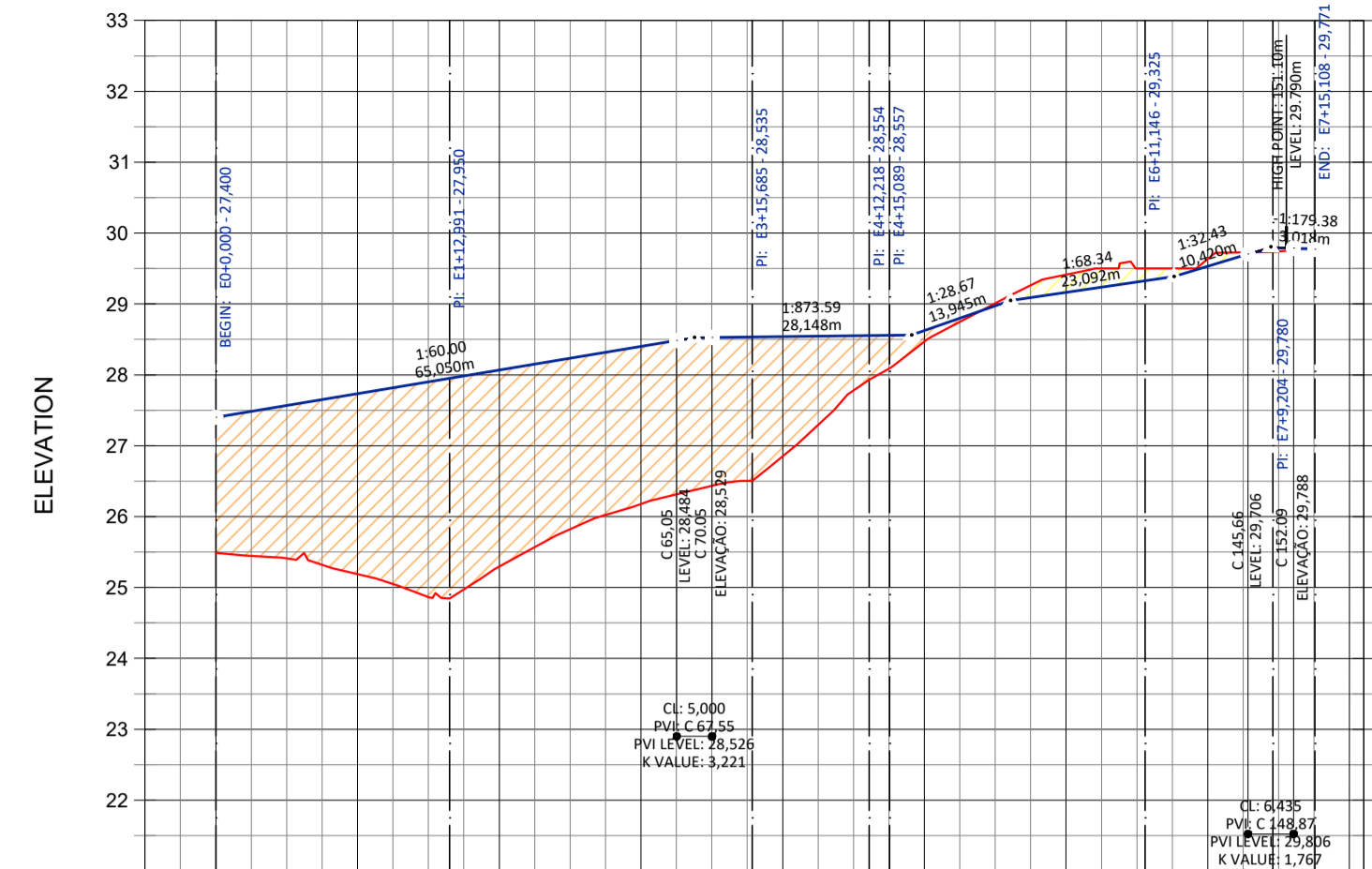

| CHAINAGE        | 0.00   | 20.00  | 40.00  | 60.00  | 80.00  | 100.00 | 120.00 | 140.00 | 160.00 |
|-----------------|--------|--------|--------|--------|--------|--------|--------|--------|--------|
| EXISTING GROUND | 25.468 | 25.189 | 25.206 | 26.178 | 26.850 | 26.468 | 29.414 | 29.837 | 29.837 |
| PROPOSED GROUND | 27.400 | 27.733 | 28.400 | 28.400 | 28.540 | 28.624 | 29.162 | 29.532 | 29.837 |
| CUT             | 1.91   | 2.54   | 2.77   | 2.22   | 1.69   | 0.16   | 0.28   | 0.10   |        |
| FILL            |        |        |        |        |        |        |        |        | 26.837 |

PROFILE PH2 - TENDER 1.3  
Horizontal Scale 1:1000  
Vertical Scale 1:100

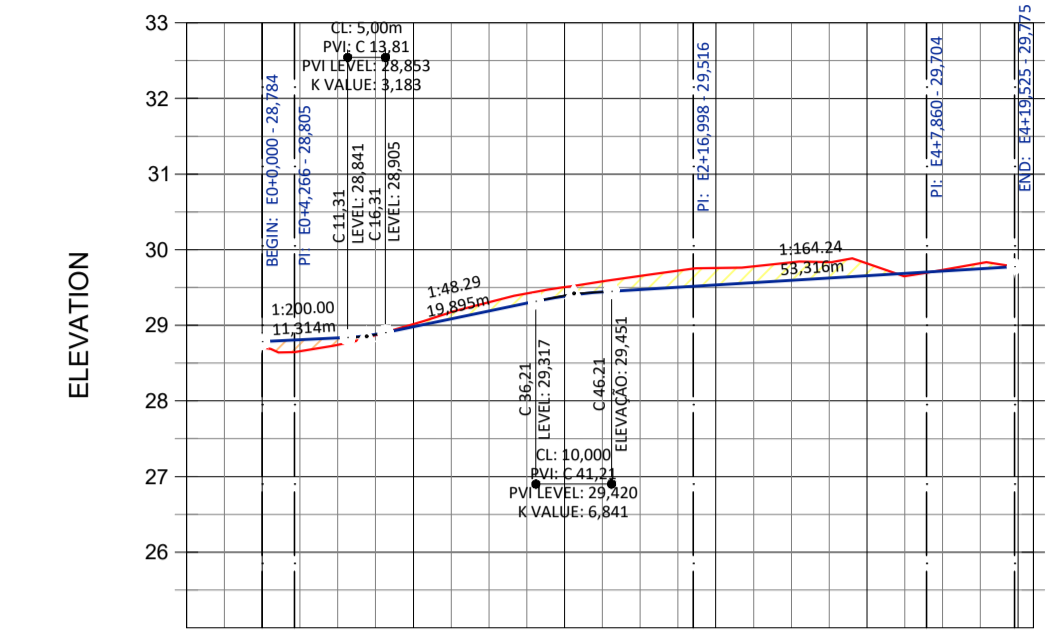

| CHAINAGE        | 0.00   | 20.00  | 40.00  | 60.00  | 80.00  | 100.00 |
|-----------------|--------|--------|--------|--------|--------|--------|
| EXISTING GROUND | 26.703 | 26.017 | 25.504 | 26.758 | 26.818 | 26.818 |
| PROPOSED GROUND | 26.764 | 26.881 | 26.885 | 26.535 | 26.867 | 26.867 |
| CUT             | 0.08   | 0.04   | 0.12   | 0.22   | 0.16   |        |
| FILL            |        |        |        |        |        | 26.867 |

PROFILE PH2 - ROAD 2.1  
Horizontal Scale 1:1000  
Vertical Scale 1:100

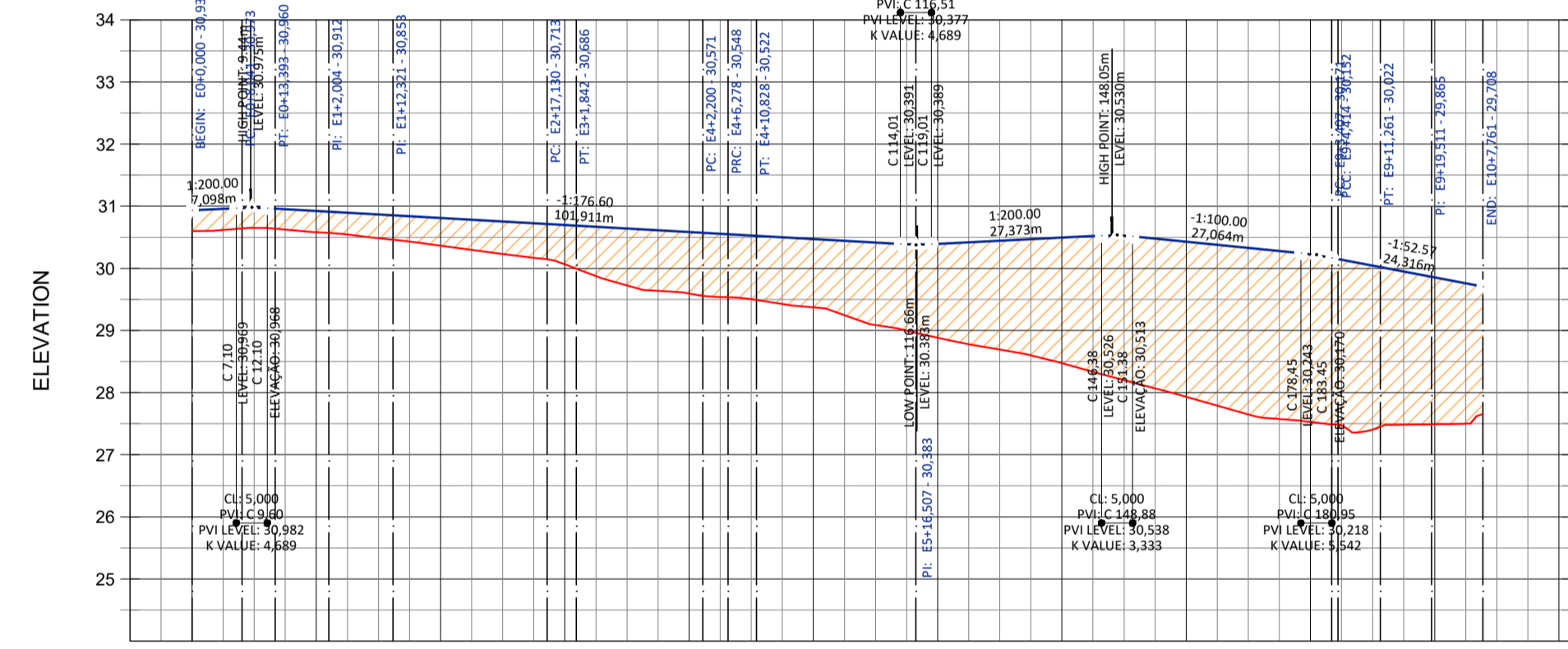

| CHAINAGE        | 0.00   | 20.00  | 40.00  | 60.00  | 80.00  | 100.00 | 120.00 | 140.00 | 160.00 | 180.00 | 200.00 | 220.00 |
|-----------------|--------|--------|--------|--------|--------|--------|--------|--------|--------|--------|--------|--------|
| EXISTING GROUND | 30.599 | 30.581 | 30.384 | 30.095 | 29.593 | 28.374 | 28.893 | 28.474 | 27.991 | 27.529 | 27.491 | 27.491 |
| PROPOSED GROUND | 30.634 | 30.623 | 30.610 | 30.697 | 30.583 | 30.470 | 30.384 | 30.225 | 30.225 | 30.225 | 29.855 | 27.491 |
| CUT             | 0.34   | 0.34   | 0.45   | 0.63   | 0.99   | 1.10   | 1.51   | 2.02   | 2.50   | 2.70   | 2.36   |        |
| FILL            |        |        |        |        |        |        |        |        |        |        |        | 26.855 |

PROFILE PH2 - ROAD 2.2  
Horizontal Scale 1:1000  
Vertical Scale 1:100

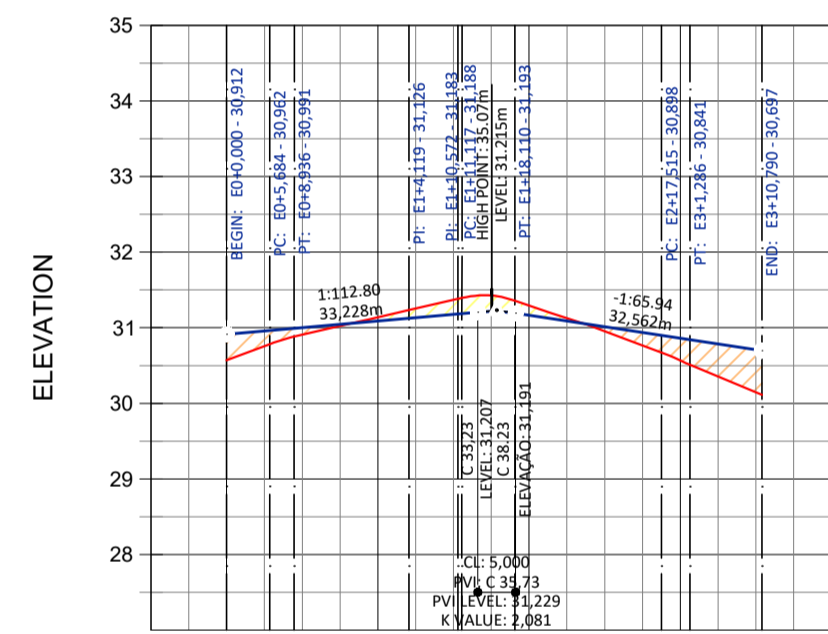

| CHAINAGE        | 0.00   | 20.00  | 40.00  | 60.00  | 80.00  |
|-----------------|--------|--------|--------|--------|--------|
| EXISTING GROUND | 30.569 | 31.137 | 31.291 | 30.568 | 30.568 |
| PROPOSED GROUND | 30.912 | 31.089 | 31.164 | 31.291 | 30.881 |
| CUT             | 0.34   | 0.05   | 0.13   | 0.28   |        |
| FILL            |        |        |        |        | 30.568 |

PROFILE PH2 - ROAD 2.3  
Horizontal Scale 1:1000  
Vertical Scale 1:100

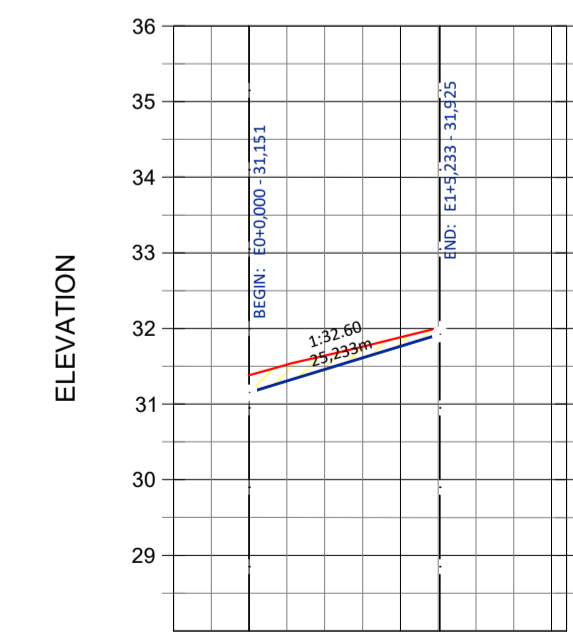

| CHAINAGE        | 0.00   | 20.00  | 40.00  |
|-----------------|--------|--------|--------|
| EXISTING GROUND | 31.381 | 31.483 | 31.483 |
| PROPOSED GROUND | 31.151 | 31.764 | 31.764 |
| CUT             | 0.23   |        |        |
| FILL            |        | 0.12   |        |

PROFILE PH2 - ROAD 2.3A  
Horizontal Scale 1:1000  
Vertical Scale 1:100

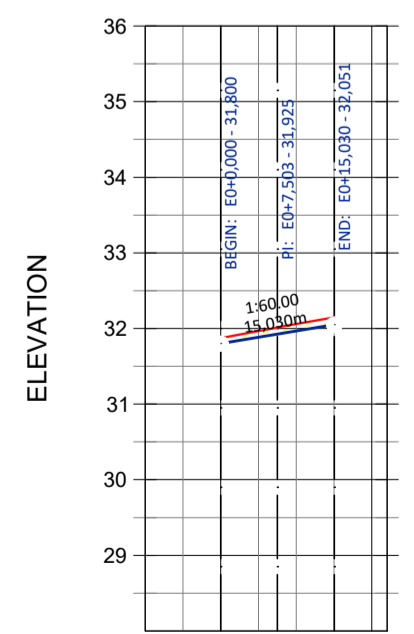

| CHAINAGE        | 0.00   | 20.00  |
|-----------------|--------|--------|
| EXISTING GROUND | 31.673 | 31.673 |
| PROPOSED GROUND | 31.800 | 31.800 |
| CUT             | 0.07   |        |
| FILL            |        |        |

PROFILE PH2 - ROAD 2.4  
Horizontal Scale 1:1000  
Vertical Scale 1:100

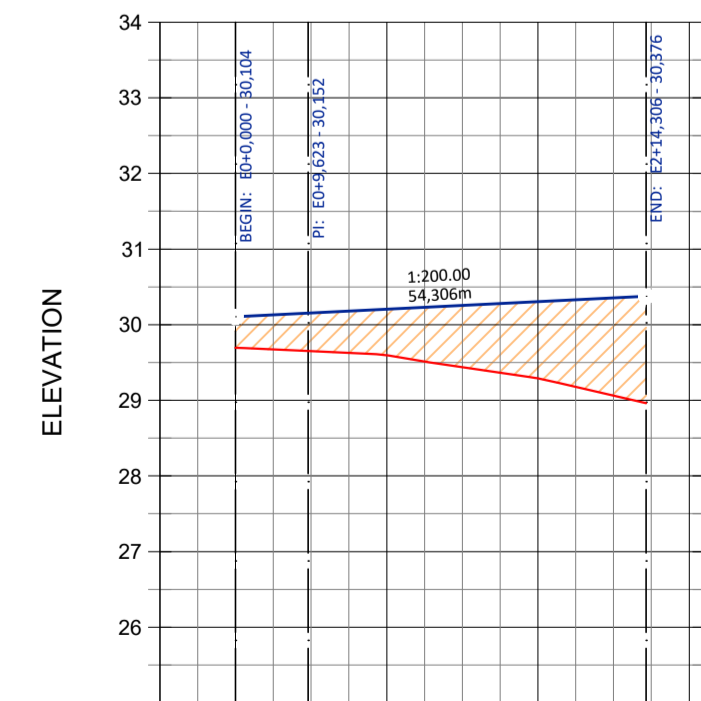

| CHAINAGE        | 0.00   | 20.00  | 40.00  | 60.00  |
|-----------------|--------|--------|--------|--------|
| EXISTING GROUND | 29.895 | 29.594 | 29.288 | 29.288 |
| PROPOSED GROUND | 30.104 | 30.204 | 30.304 | 30.304 |
| CUT             | 0.41   | 0.61   | 1.02   |        |
| FILL            |        |        |        | 29.288 |

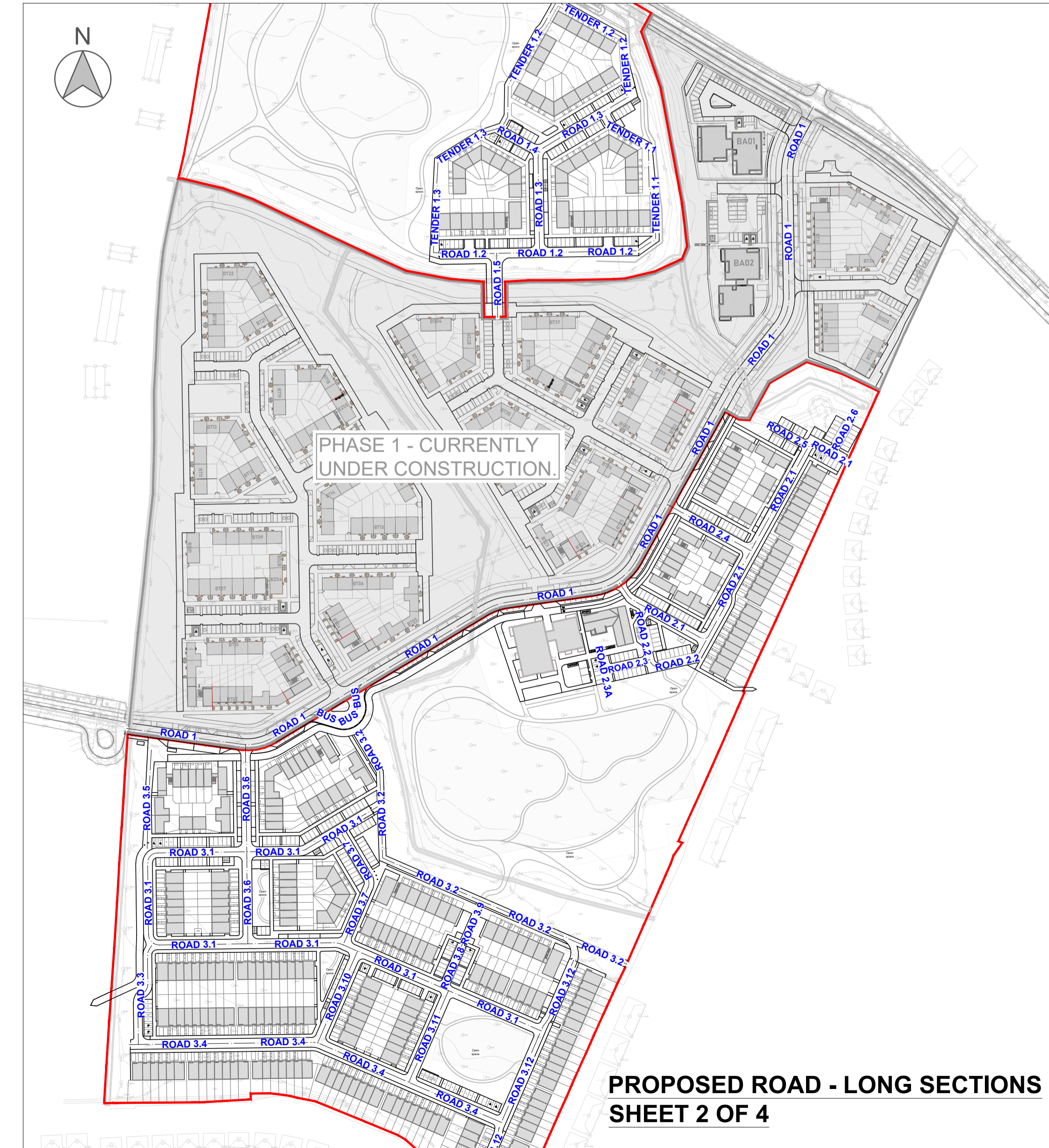

NOTES

- NO PART OF THIS DRAWING MAY BE REPRODUCED OR TRANSMITTED IN ANY FORM OR STORED IN ANY RETRIEVAL SYSTEM OF ANY NATURE WITHOUT THE WRITTEN PERMISSION OF AKM DESIGN AS COPYRIGHT HOLDER, EXCEPT AS AGREED FOR USE ON THE PROJECT FOR WHICH THE DRAWING IS ORIGINALLY ISSUED.
- ALL DIMENSIONS ARE IN M UNLESS OTHERWISE NOTED.
- THE CONTRACTOR SHALL CHECK ALL DIMENSIONS PRIOR TO COMMENCEMENT OF CONSTRUCTION. DISCREPANCIES SHALL BE REPORTED TO THIS OFFICE IN WRITING.
- ALL WORKS TO NATIONAL AND REGIONAL ROADS TO BE CONSTRUCTED IN ACCORDANCE WITH THE NRA SPECIFICATION FOR ROAD WORKS UNLESS OVERRIDDEN BY LOCAL OVERSEEING AUTHORITY'S STANDARDS. ALL WORKS TO PRIVATE ROADS WITH RESIDENTIAL DEVELOPMENT TO BE TO LOCAL AUTHORITY STANDARDS & RECOMMENDATIONS FOR SITE DEVELOPMENT WORKS.
- ALL ROAD MARKINGS & SIGNS SHALL COMPLY FULLY WITH THE TRAFFIC SIGNS MANUAL PUBLISHED BY THE DEPARTMENT OF TRANSPORT, JUNE 2010.
- SIGNS & MARKINGS: CONTRACTOR TO CONFIRM PRECISE SETTING OUT WITH EMPLOYERS REPRESENTATIVE PRIOR TO COMPLETION.
- ALL SIGNS TO BE MOUNTED ON 76mm GALVANIZED STEEL POSTS WITH COLORED SLEEVES U.N.O. TO SPECIFICATION AND IN ACCORDANCE WITH THE TRAFFIC SIGNS MANUAL: MOUNTING HEIGHT TO BOTTOM OF SIGN = 2.3m U.N.O.
- ALL TRAFFIC MANAGEMENT TO COMPLY FULLY WITH THE PROVISIONS OF CHAPTER 8 OF THE TRAFFIC SIGNS MANUAL.
- ALL CO-ORDINATES ARE TO ITM (IRISH TRANSVERSE MERCATOR).
- ALL LEVELS ARE TO ORDNANCE DATUM AND ARE IN METERS.
- ALL EXISTING SIGNS (INCLUDING POLES) AND MARKINGS TO BE TAKEN UP OR COVERED AND TEMPORARY MEASURES APPLIED IN ACCORDANCE WITH CONTRACTORS TRAFFIC MANAGEMENT PLAN. THE CONTRACTOR MAY USE EXISTING SIGNAGE AS PART OF THEIR TRAFFIC MANAGEMENT PLAN.
- ALL EXISTING CHAMBERS AND ACCESS POINTS TO REMAIN CLEAR OF OBSTRUCTION THROUGHOUT WORKS. CHAMBERS SHALL BE REBUILT/RETAINED IN POSITION IDENTIFIED ON SITE SERVICES LAYOUT DRAWING.
- ALL PEDESTRIAN, CYCLE AND VEHICULAR ROUTES MUST BE RETAINED IN ACCORDANCE WITH APPROVED TRAFFIC MANAGEMENT PLAN.
- ALL MATERIALS TO BE DISPOSED OFF SITE SHALL BE TAKEN TO A LICENSED FACILITY APPROVED BY THE LOCAL OVERSEEING AUTHORITY.

LEGEND

- EXISTING GROUND LEVEL
- PROPOSED ROAD LEVEL
- CUT
- FILL

COPYRIGHT RESERVED. ALL DRAWINGS TO BE READ IN CONJUNCTION WITH ARCHITECTURE, STRUCTURAL ENGINEERS & MECHANICAL ENGINEERS DETAILS.

DO NOT SCALE DRAWING. USE FIGURED DIMENSIONS ONLY. ALL DISCREPANCIES TO BE REPORTED TO AKM DESIGN GROUP IMMEDIATELY. ALL DIMENSIONS TO BE CHECKED ON SITE BY MAIN CONTRACTOR PRIOR TO CONSTRUCTION. MAIN CONTRACTOR IS RESPONSIBLE FOR SET-OUT.

| DESCRIPTION | REV | DATE  |
|-------------|-----|-------|
| FIRST ISSUE | 00  | 04/26 |

**AKM DESIGN GROUP.**  
Innovating tomorrow through design  
14 Riverwalk, Citywest, Dublin 24, D24 XN32  
T: +353 1 479 6234 E: info@akmdesign.ie akmdesign.ie

STAGE:  
**S2 - FOR INFORMATION**

| DRAWN BY:        | APPROVED BY:                             | AKM JOB NUMBER: |
|------------------|--|-----------------|
| DM               | CK                                       | 25051           |
| DATE:            | SCALE:                                   |                 |
| 04/26            | Horizontal 1:1000<br>Vertical 1:200 @ A1 |                 |
| REVISION NUMBER: | SEQUENCE NUMBER:                         |                 |
| 00               | 540002                                   |                 |

DOCUMENT NO:  
25051-AKM-XXXX-XX-DR-C01-540002

PROJECT TITLE:  
25051 - FINGAL MOORETOWN PHASE 2

DRAWING TITLE:  
PROPOSED ROAD LONG SECTIONS  
SHEET 2 OF 4

CLIENT:  
FINGAL COUNTY COUNCIL